

PRYME[®] RADIO PRODUCTS

PRYMEBLU BTH-SPM100-ZD Wireless Bluetooth Speaker Microphone

For use with Zello and other push-to-talk apps on Android smart phones.



Model No.: BTH-SPM100-ZD
Made in Taiwan

PRYME and PRYMEBLU[®] are trademarks owned by PRYME Radio Products, Brea CA. All other product or service names are the property of their respective owners. © 2014 PRYME Radio Products, Brea CA. All Rights Reserved

Federal Communication Commission Interference Statement

This equipment has been tested and found to comply with the limits for a Class B digital device, pursuant to Part 15 of the FCC Rules. These limits are designed to provide reasonable protection against harmful interference in a residential installation. This equipment generates uses and can radiate radio frequency energy and, if not installed and used in accordance with the instructions, may cause harmful interference to radio communications. However, there is no guarantee that interference will not occur in a particular installation. If this equipment does cause harmful interference to radio or television reception, which can be determined by turning the equipment off and on, the user is encouraged to try to correct the interference by one of the following measures:

- Reorient or relocate the receiving antenna.
- Increase the separation between the equipment and receiver.
- Connect the equipment into an outlet on a circuit different from that to which the receiver is connected.
- Consult the dealer or an experienced radio/TV technician for help.

FCC Caution: Any changes or modifications not expressly approved by the party responsible for compliance could void the user's authority to operate this equipment.

This device complies with Part 15 of the FCC Rules. Operation is subject to the following two conditions: (1) This device may not cause harmful interference, and (2) this device must accept any interference received, including interference that may cause undesired operation.

This equipment complies with FCC RF radiation exposure limits set forth for an uncontrolled environment. To maintain compliance with FCC RF exposure compliance requirements, please avoid direct contact to the transmitting antenna during transmitting.

RF Exposure Warning!

This device contains transmitters and receivers which emit Radio Frequency (RF) energy. The device is designed to comply with the limits for exposure to RF energy set by the Federal Communications Commission (FCC) of the United States, Industry Canada (IC) or Canada, and the regulating entities of other countries.

If you are still concerned about exposure to RF energy, you can further limit your exposure by limiting the amount of time you use the equipment or by placing more distance between your body and the device, since exposure level drops off dramatically with distance.

PRYME[®] RADIO PRODUCTS

911 Mariner St., Brea, CA 92821
PH: 714.257.0300 FAX: 714.257.0600
TOLL FREE: 800.666.2654
WWW.PRYME.COM

1.0Z-September 2014

Charging the Speaker Microphone

The BTH-SPM100-ZD speaker microphone has an internal Lithium Ion rechargeable battery pack which must be charged prior to operation, and must be recharged regularly. A fully charged battery will provide approximately 5 hours (or more) of continuous operation before needing to be recharged. However, operating time can vary depending on usage and the condition of the battery pack. Recharge the battery regularly.



To charge the speaker microphone

1. Ensure the device is turned off using the multifunction button.
2. Plug the charge cable into any powered USB outlet, such as the included AC wall charger, and then into the charge jack on the bottom of the speaker microphone. You will need to remove the protective rubber cover that is inserted into the charge jack. (To prevent dust and moisture from damaging your speaker microphone, always ensure this cover is in place when you are not charging.)
3. Once the charging process has begun, the LED indicator on the bottom of the speaker microphone will show a constant red light.
4. Typical charge time is approximately three hours. Actual charge time will vary depending on several factors including the battery's charge state, condition, and age.
5. Disconnect the charger from the adapter when charging is completed.

Charging Cautions:

- Do not use a wall charger or charge cable that appears to be damaged. (Example: frayed wires, melted plastic, etc.) Contact PRYME to get a new manufacturer-approved replacement charger.
- Do not tamper with or modify the speaker microphone or charger.
- Always turn the speaker microphone off when charging.

Controls and Connection



2

Pairing with a Smartphone



The BTH-SPM100-ZD speaker microphone is designed to work with smartphones running the Android operating system. Prior to normal operation, the phone and speaker microphone must be paired together using the following process:

1. Activate the pairing mode on the speaker microphone by holding down the multifunction button until the status LED flashes BLUE-RED-BLUE-RED continuously in sequence.
2. On your phone, go to **Settings > Bluetooth**. Move the Bluetooth slider to turn the phone's Bluetooth radio on.
3. Select "Search for Devices" from the phone's Bluetooth menu. The phone will scan for nearby Bluetooth devices and a list showing the names of nearby Bluetooth devices will be shown on the screen.
4. Choose "BTH-SPM100-ZD" from the list.
5. Keep the phone and speaker mic near each other and wait a few seconds. The devices will pair to each other.

Reconnecting a Previously Paired Speaker Microphone and Phone

Once the speaker microphone and phone have been successfully paired together, both devices will remember that connection. They will reestablish their link whenever the speaker microphone and phone are both powered on and in within range of each other, as long as the Bluetooth radio is enabled in the phone. Re-establishing this connection can take 10-60 seconds.

In the event that the phone and speaker microphone do not automatically reestablish their link, simply press the multifunction button on the BTH-SPM100-ZD to restore the connection.

Setting Up the Zello App

To get the Zello app on your phone and set it up to work with the BTH-SPM100-ZD speaker microphone, do the following:

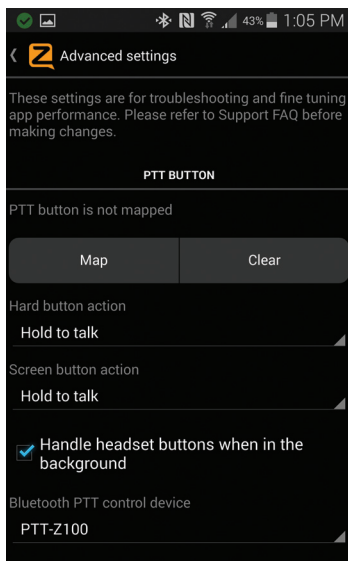

1. Install Zello from your Zello@Work network, or download the app from the Google Play store.
2. Make sure that your phone's Bluetooth radio is enabled, and that the speaker microphone is powered on and that the microphone and phone are connected to each other.
3. Open Zello and go to **Menu > Options > Under the Hood**.
4. Under "Bluetooth PTT Control," choose "PTT-Z100". You should see a popup indicating the device control has been activated. If you don't see it, you may need to power cycle the headset and repeat this step.
5. Open the Talk screen in Zello (the screen with a big round button). In the bottom-left corner of the screen, tap-hold and slide to the Bluetooth icon to activate the speaker microphone in Zello.

5

OPTIONAL EARRHONES

Although the BTH-SPM100-ZD has a built-in speaker for listening to received calls, some users may prefer to use a listen only earphone for enhanced privacy. The accessory jack on the speaker microphone will accept any mono earphone with a 3.5 mm audio plug. When an earphone is used, the front-firing speaker is disabled.

PRYME EH-1389SC model shown.
Earphone sold separately.



PRYME makes a variety of listen-only earphones in different styles that will work with the BTH-SPM100.

Model	Earphone Style	Cable Length/Type	Connector
EH-389SC	Rubber Ear Hook	15" Coiled	3.5 mm right-angle
EH-389XC	Rubber Ear Hook	25" Coiled	3.5 mm right-angle
EH-1289SC	Plastic D-Ring	15" Coiled	3.5 mm right-angle
EH-1289XC	Plastic D-Ring	25" Coiled	3.5 mm right-angle
EH-1389SC	Acoustic Tube	15" Coiled	3.5 mm right-angle
EH-1389X	Acoustic Tube	30" Straight	3.5 mm right-angle
EH-1399X	Acoustic Tube	30" Straight	3.5 mm straight

SPECIFICATIONS

Bluetooth Version:	v2.1+EDR
Speaker Output:	1 watt
Maximum Audio Level:	126 dB
Receiver Sensitivity:	-82 dBm (typ.)
Power Class:	Bluetooth class 2
Range:	10 meters
Display:	Blue and Red
Bluetooth Profile:	HFP,HSP,SPP Profile
Operating Voltage:	5 VDC
Battery Capacity:	240 mAh
Operating Time (Standby)	> 50 hours
Operating Time (Typical)	> 11 hours
Operating Time (Continuous Talk)	> 5 hours
Push-to-Talk Function:	Built-in
Operating Temperature:	-70°F to +120°F (approx.)
Weight:	60 grams (approx.)

7

Using the Speaker Microphone with Zello

Once setup, you will be able to use the speaker microphone with the Zello app, even if Zello is running the background.

-To activate Zello's push-to-talk feature, press and hold the PTT button on the speaker microphone.

-When Zello is transmitting a call, audio will be picked up by the BTH-SPM100-ZD's built-in microphone.

-Incoming calls received by Zello will be heard over the BTH-SPM100-ZD's built-in speaker or through the optional earphone if you are using one.

Making and Receiving Phone Calls

You can also use the speaker microphone to make and receive phone calls.

-You can initiate a phone call by using the Phone Dialer app in the phone.

-Phone audio will be routed to the BTH-SPM100-ZD's built-in microphone and speaker (or earphone, if you are using one).

-To answer an incoming call, press the PTT button on the speaker microphone.

-While on a call, you can press the PTT button on the speaker microphone to hang up the phone and end the call.

STATUS LED MESSAGES

The meanings of the various status LED messages shown by the speaker microphone are shown on the following table:

LED INDICATION	MEANING
Constant Red (while plugged into charger)	Charge mode
Constant Red and Blue (while plugged into charger)	Charging is finished
Flashes red-blue-red-blue repeatedly	Pairing mode
Two blue flashes every two seconds	Speaker microphone is powered on but not paired
One blue flash every two seconds	Speaker Microphone is powered and paired
Constant red with one blue flash every two seconds	PTT is pressed
No indication	Speaker microphone is powered off

6

SUPPORT AND WARRANTY

PRYME Radio Products warrants this product against defects in materials or workmanship for a period of one year from the date of retail purchase. PRYME will repair or replace a defective unit, at our option, without charge for parts or labor. The limited warranty is extended only to the original purchaser and is valid only to consumers in the United States and Canada. It does not cover damage or failure caused by or attributable to Acts of God, abuse, misuse, improper or abnormal usage, faulty installation, improper maintenance, lightning, or other incidences of excessive voltage, or any tampering or repairs by other than a PRYME authorized repair facility. It does not cover replacement of consumable parts, transportation costs, or damage in transit.

Repair or replacement under the terms of this warranty does not extend the terms of this warranty. This warranty can only be modified by an officer of PRYME Radio Products, and then only in writing. Should this product prove defective in workmanship or material, the consumer's sole remedies shall be such repair or replacement as provided by the terms of this warranty. Under no circumstances shall PRYME Radio Products be liable for any loss or damage, direct, consequential, or incidental, arising out of the use of or inability to use this product. Some states do not allow limitations on how long an implied warranty lasts or the exclusions or limitations of incidental or consequential damages, so the above limitations or exclusions may not apply to you. This warranty gives you specific legal rights. You may also have other rights, which may vary, from state to state.

For support or warranty service on your PRYME product, contact us at 1-800-666-2654 or visit us on the web at www.PRYME.com.

COPYRIGHT AND TRADEMARK INFO

© 2014 PRYME Radio Products, Brea CA. All rights reserved.

PRYME® and PRYMEBLU® are trademarks owned by PRYME Radio Products, Brea CA.

Android is a trademark of Google Inc.

All other product or service names are the property of their respective owners.

DISCLAIMER: The Bluetooth wireless link used by PRYMEBLU products is an open standard, unsecured technology. As such, it is not recommended for first-responder or other mission critical users.

8